



Before & After



2918 Laurentide, Ann Arbor Township: Ann Arbor

Our Goal with this remodel was to transform a mundane 1960's home with a dark and closed layout into a light filled, functional, contemporary space. Our design/build solution incorporates two subtle changes to improve the functionality and cohesion of the first floor plan. A new front entry addition and the relocation of the stairway opens up the first floor allowing light and views from the front of the house to the back. Additionally, an enlarged bamboo kitchen with concrete countertops and an open tread staircase establish a light and contemporary aesthetic that is carried throughout the interior and exterior remodel. A first floor laundry, home office, and multipurpose room were also created to add function and versatility to the home.



Floor Plan

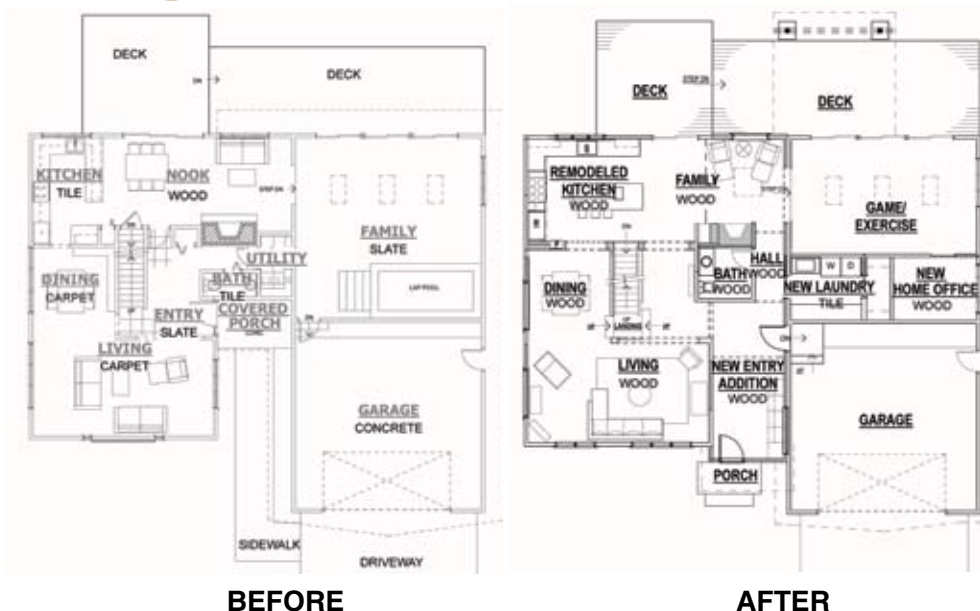

forward
designers & builders

Contact Information

3915 Research Park
Suite A 13
Ann Arbor, MI 48108
Office: (734) 761-8403
www.planforward.net